

An abstract architectural rendering featuring two large, translucent spheres. The left sphere is a vibrant red, while the right one is a muted grey. Both spheres are filled with intricate, glowing wireframe structures in yellow, blue, and green, resembling complex engineering or architectural models. The spheres are positioned against a dark, almost black background, creating a sense of depth and futuristic design.

# AEC Investor Webinar

**Jay Bhatt**

**September 14, 2011**

# Safe Harbor Statement

This presentation contains forward looking statements about future results, performance or achievements, financial and otherwise. These statements reflect management's current expectations, estimates and assumptions based on the information currently available to Autodesk. These forward-looking statements are not guarantees of future performance and involve risks, uncertainties and other factors that may cause Autodesk's actual results, performance or achievements to be materially different from results, performance or achievements expressed or implied by the forward-looking statements contained in this presentation. A discussion of the factors that may affect future results is contained in Autodesk's most recent SEC filings, including descriptions of the risk factors that may impact Autodesk and the forward-looking statements made in this presentation. The forward-looking statements made in this presentation are being made as of the time and date of its live presentation. If this presentation is reviewed after the time and date of its live presentation, even if it subsequently is made available by Autodesk, on its Web site or otherwise, this presentation may not contain current or accurate information. Autodesk disclaims any obligation to update or revise any forward-looking statement based on new information, future events or otherwise.

# Autodesk AEC Revenue

\$Millions

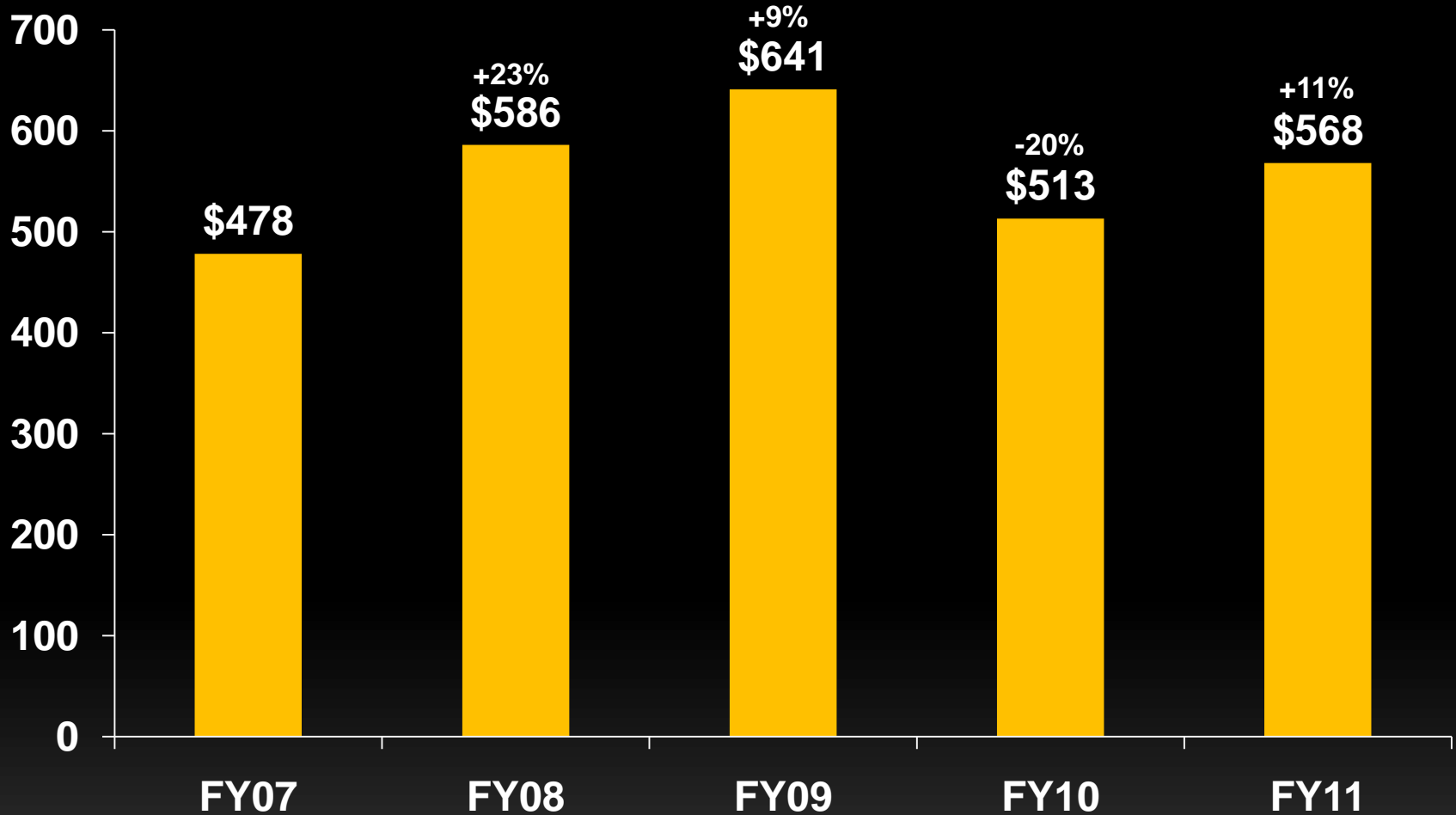

# Autodesk AEC Revenue Q2 FY12

\$Millions

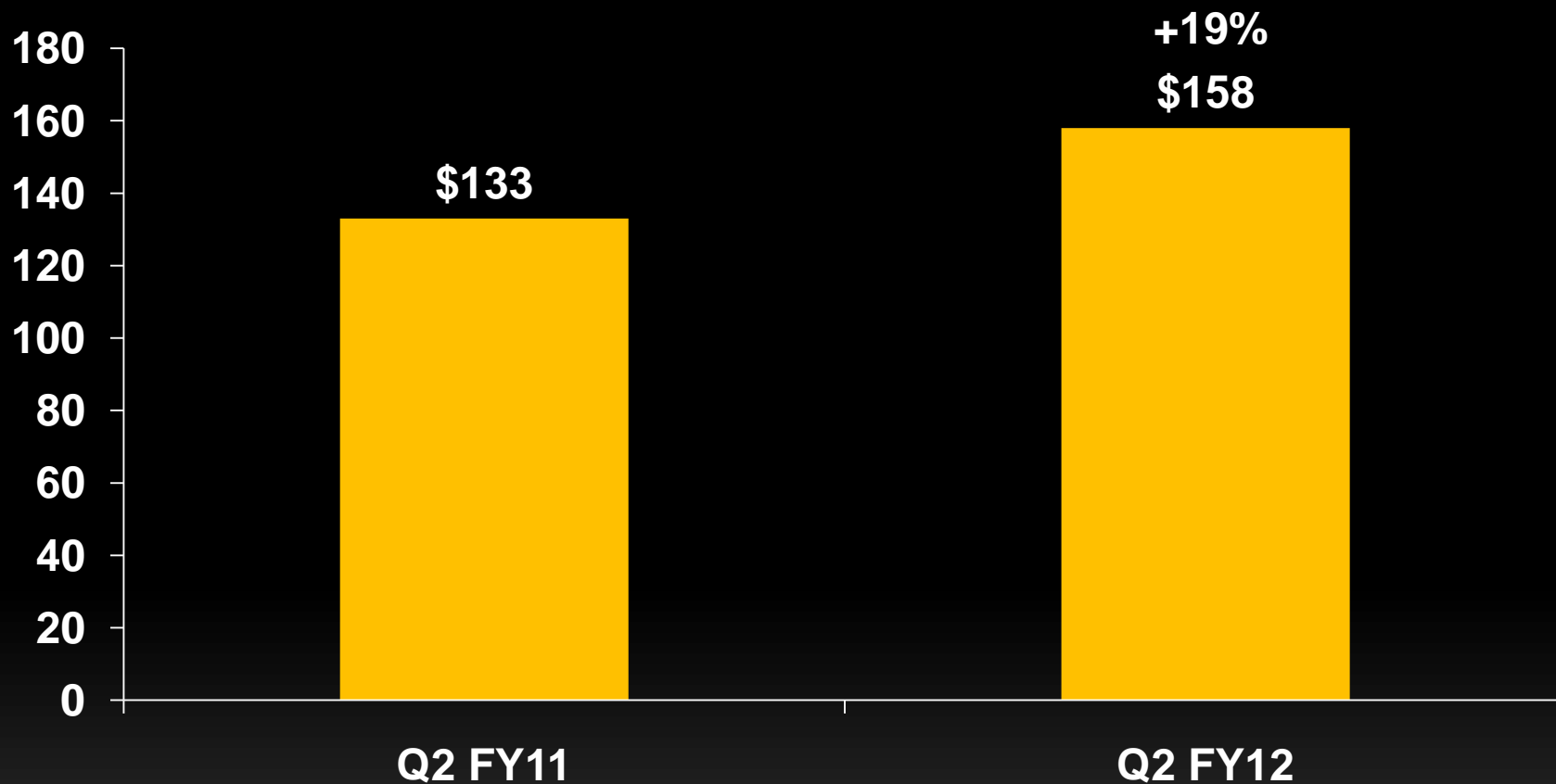

# Strategic Growth in AEC

 Autodesk Customer Base

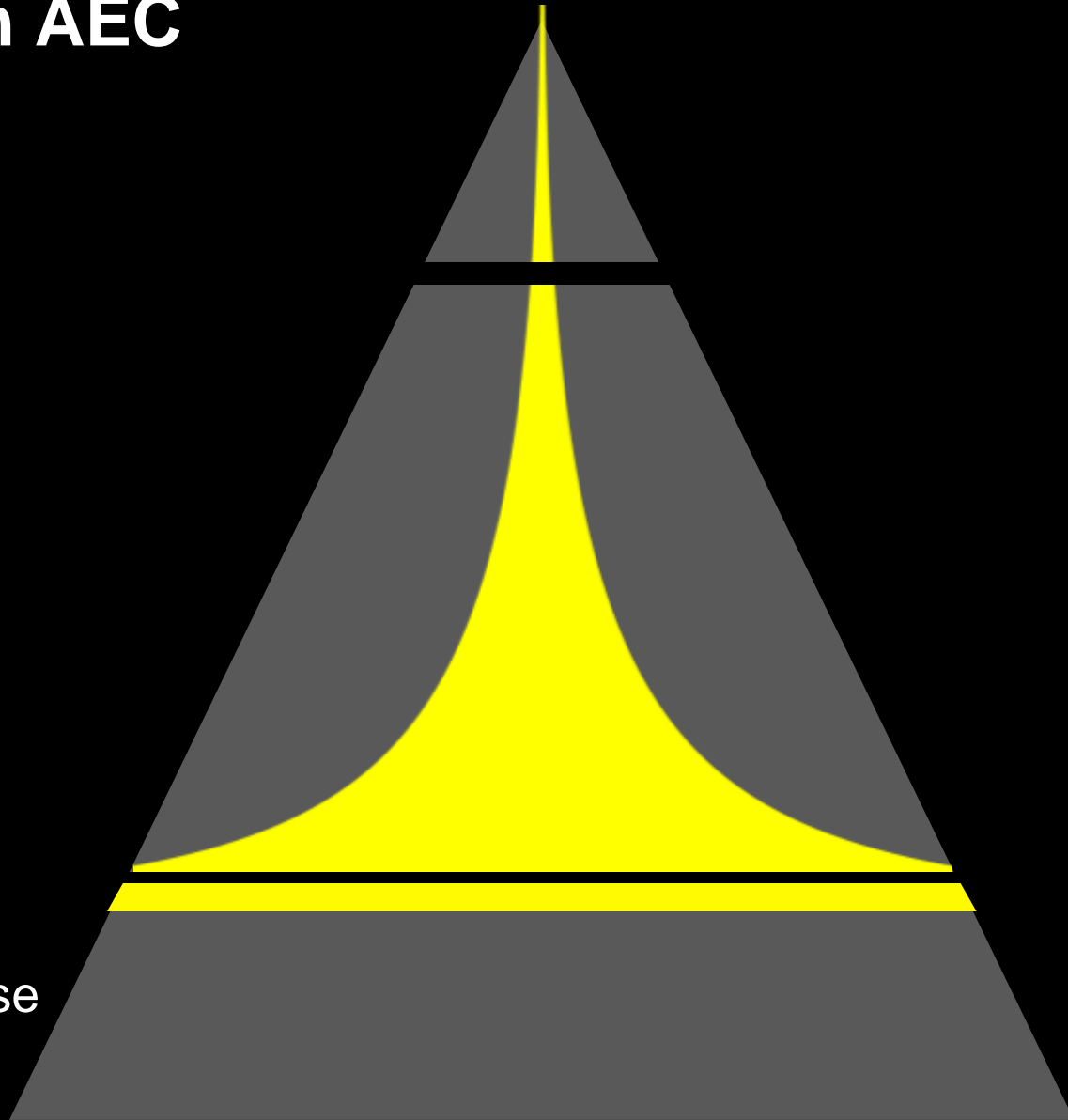

# Strategic Growth in AEC



Building Information Modeling

Influence the Value Chain

Expanding Share of Wallet

New Segments

Suites

-  Autodesk Customer Base
-  Expansion Opportunity

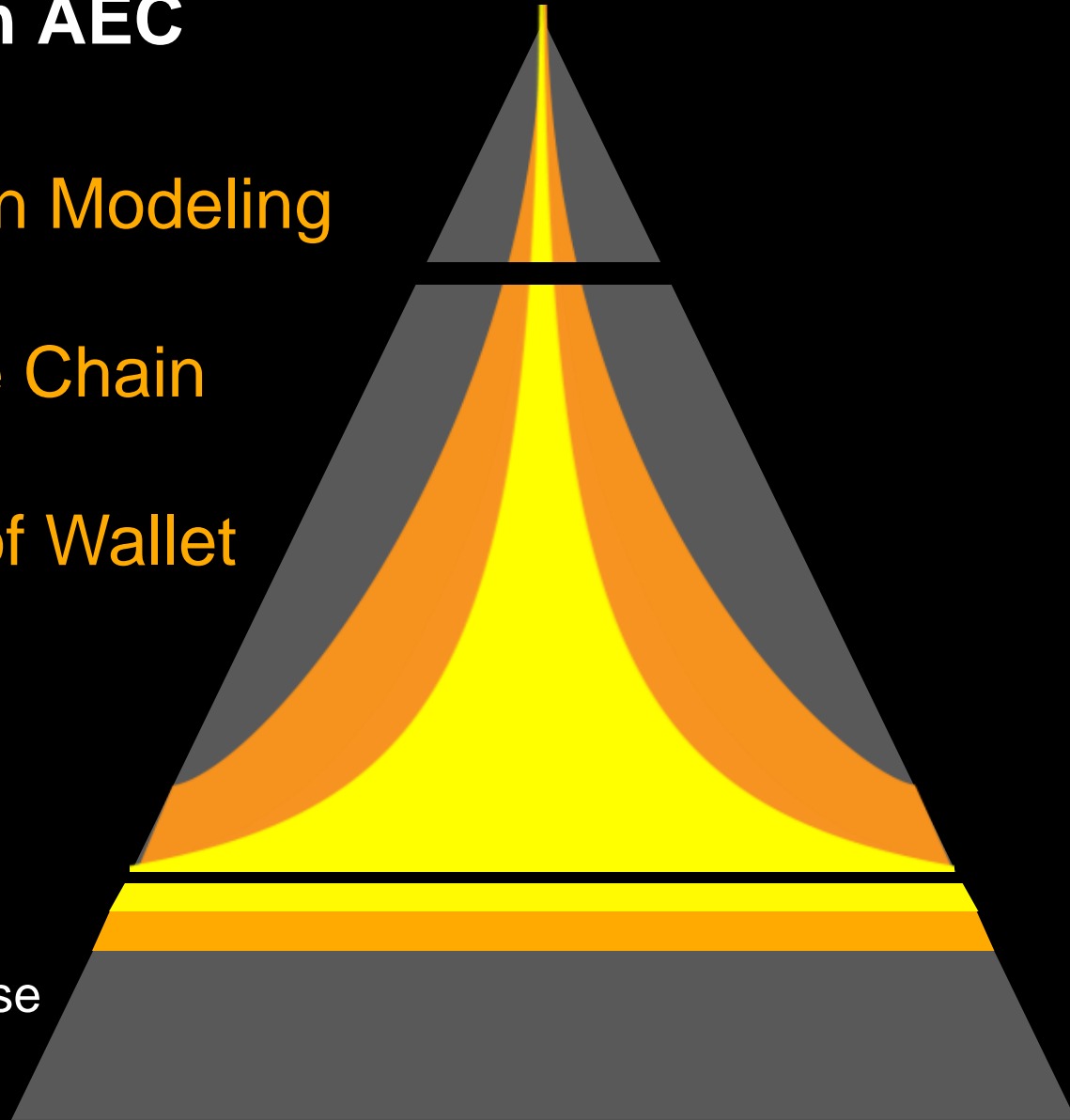



# Industry Challenges & Opportunities

- Urbanization
- Natural Resources
- Competition
- Complexity
- Technology



# Building Information Modeling

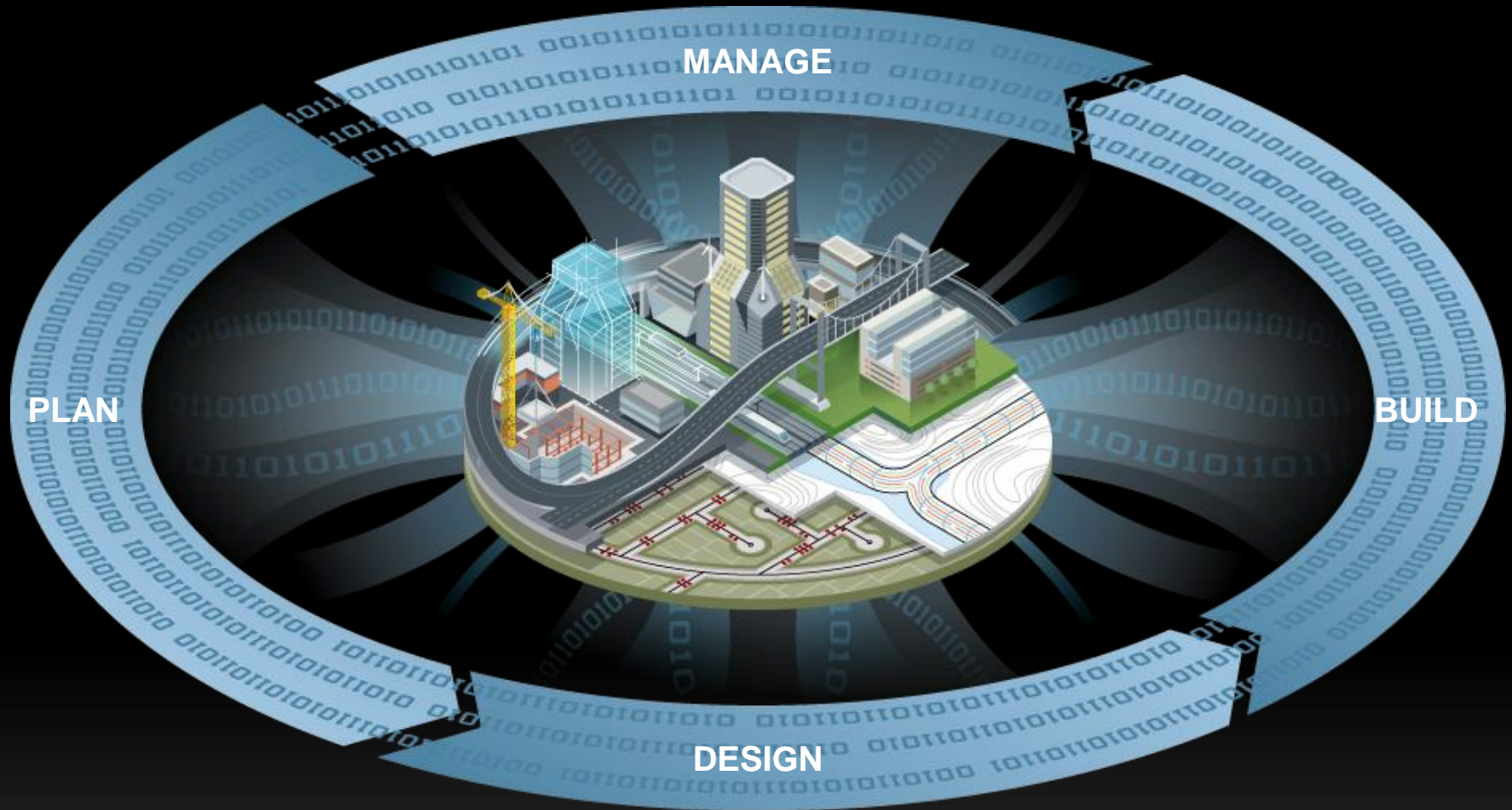

Source: McGraw-Hill Construction, 2009, 2010



# Influence the Value Chain

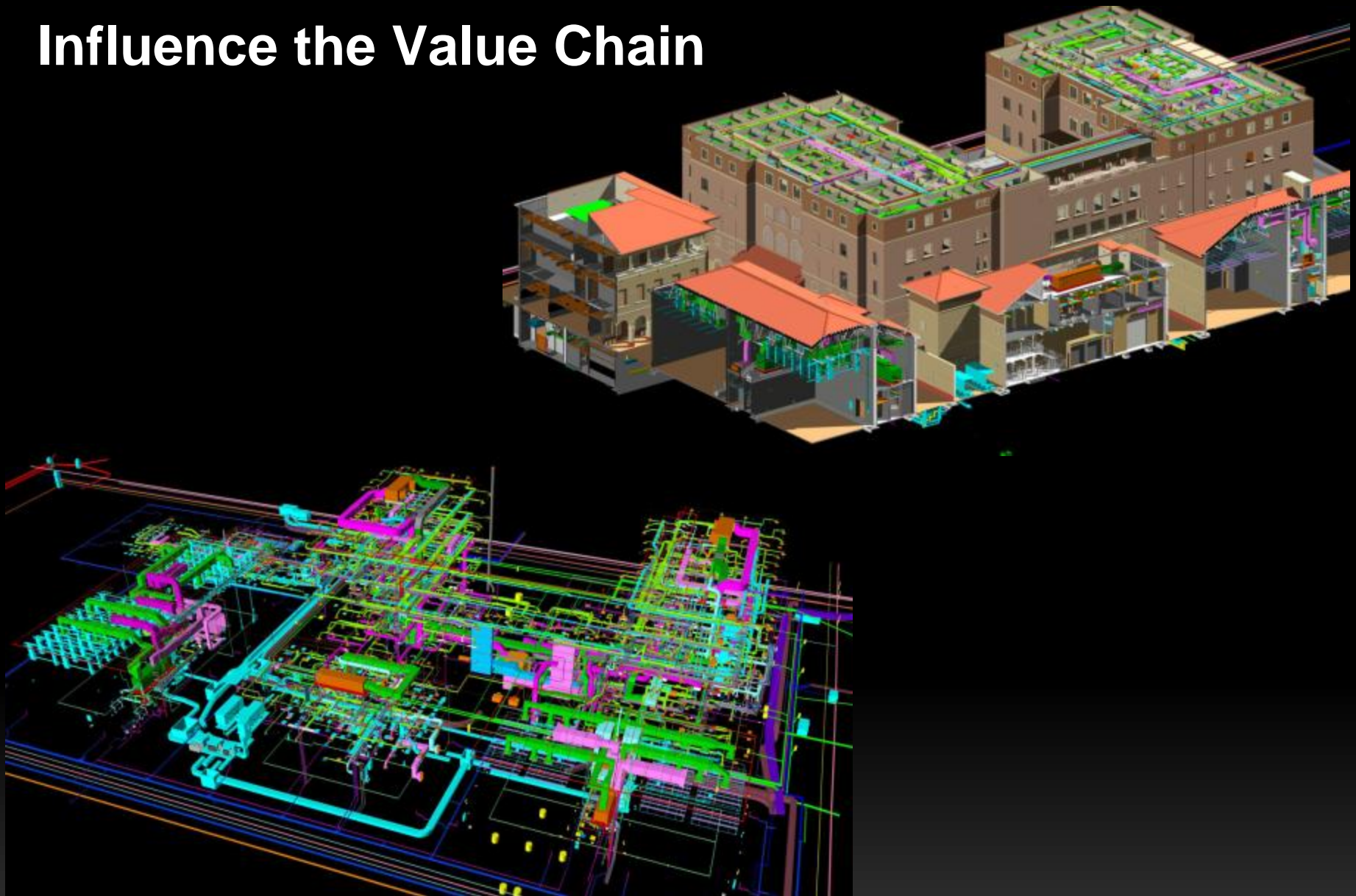

# Expanding Share of Wallet – Building Engineering & Construction



Image courtesy of ATP



# New Segments – Autodesk Infrastructure Modeler

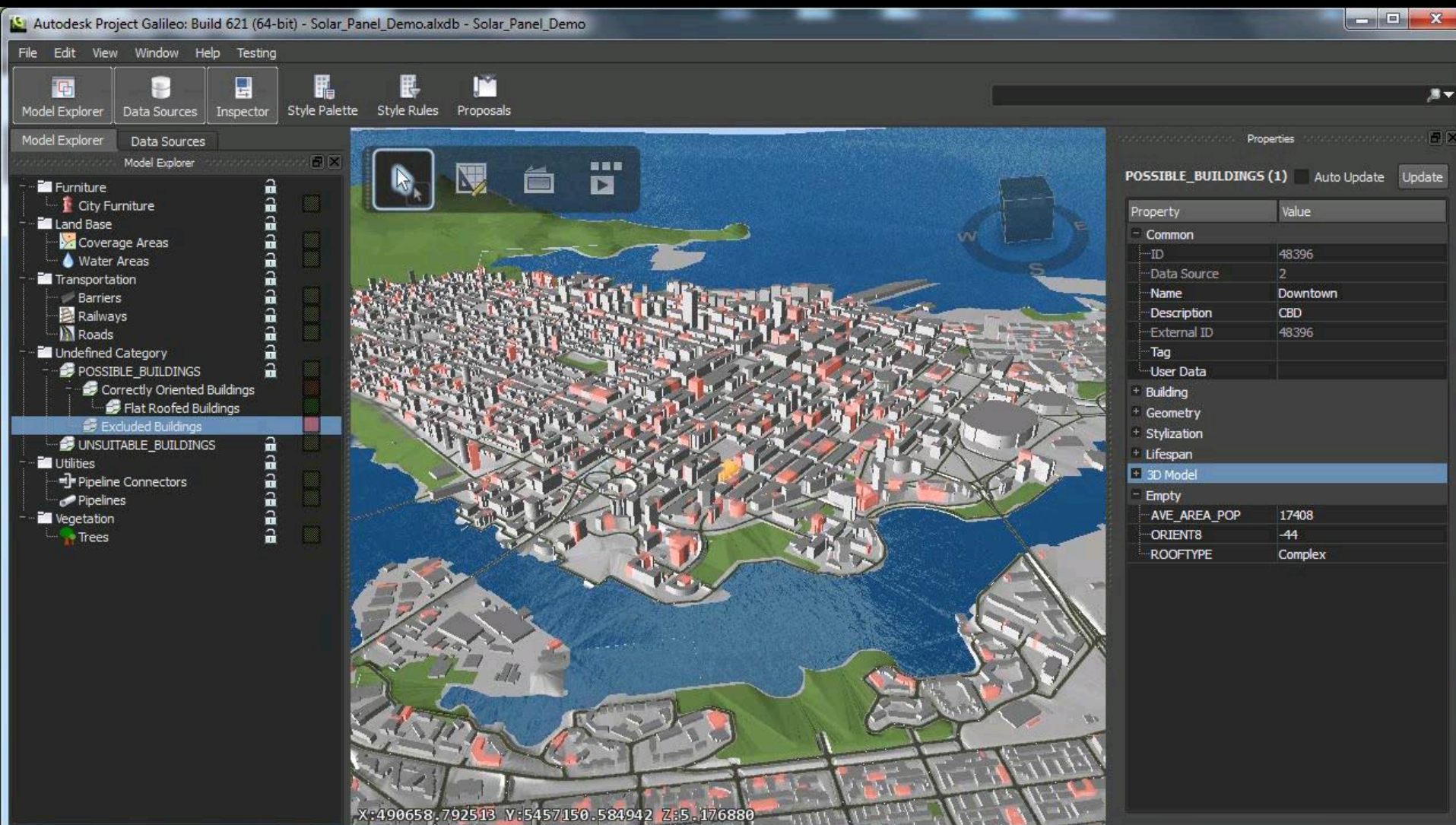

# New Segments – Autodesk Utility Design

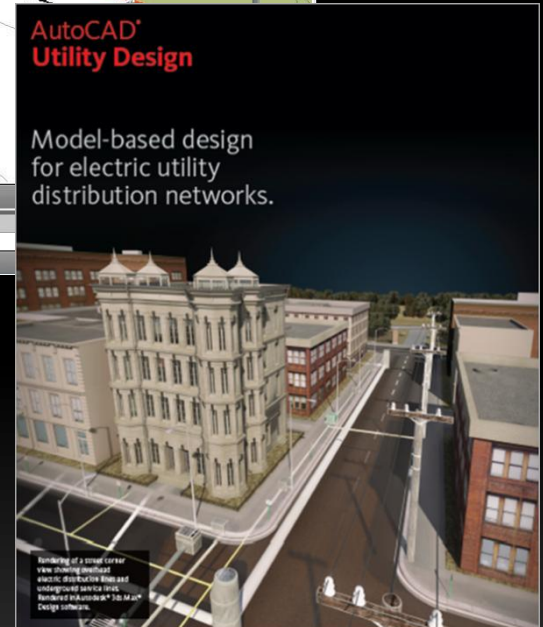
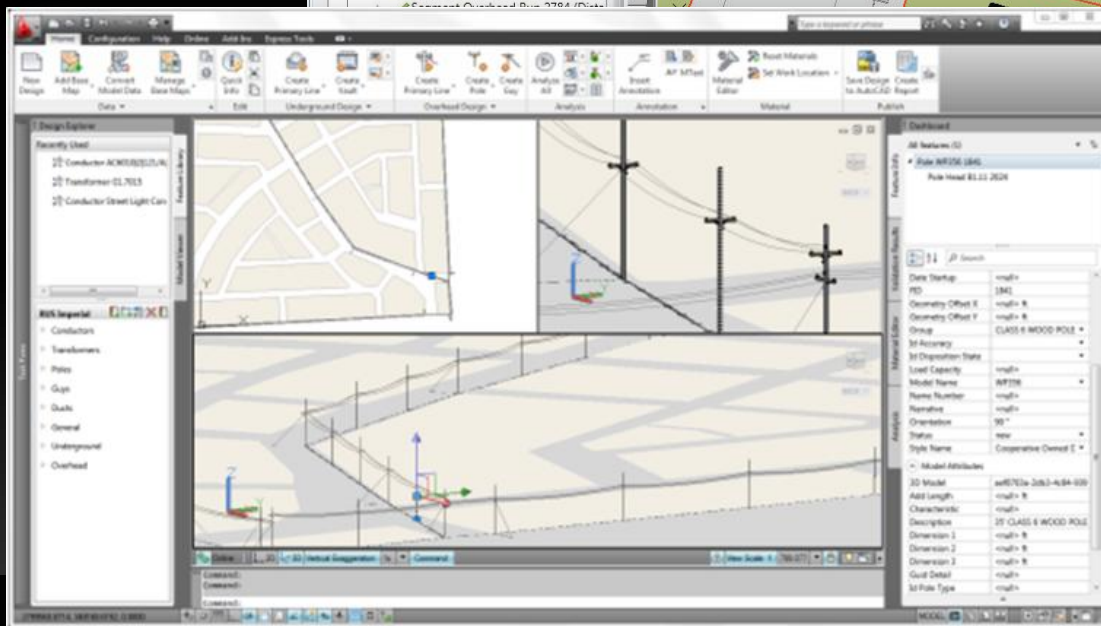
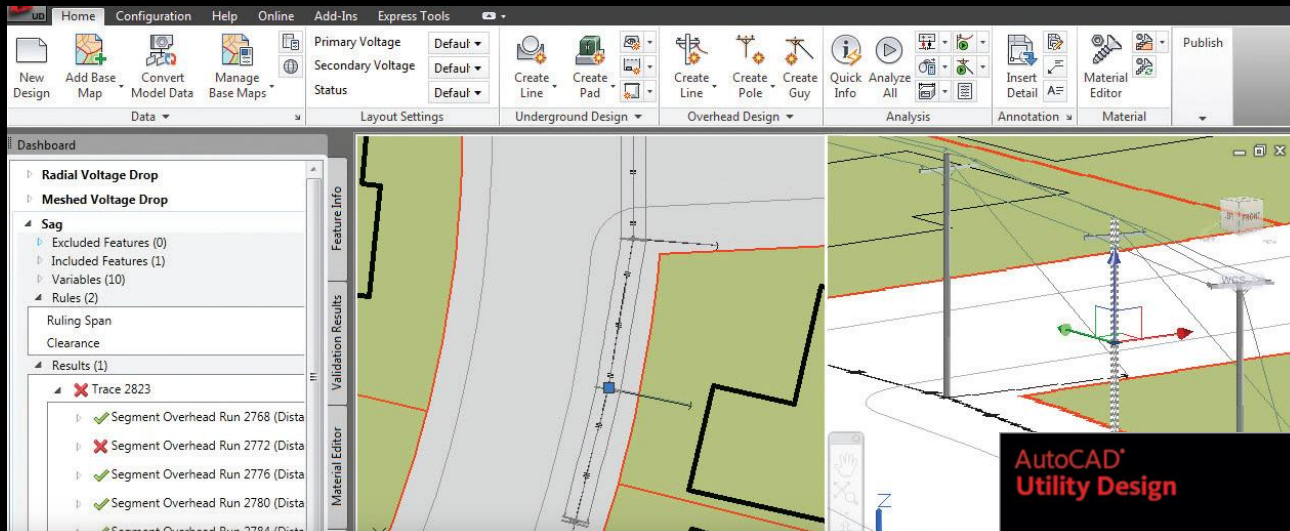



# New Segments – Process & Plant

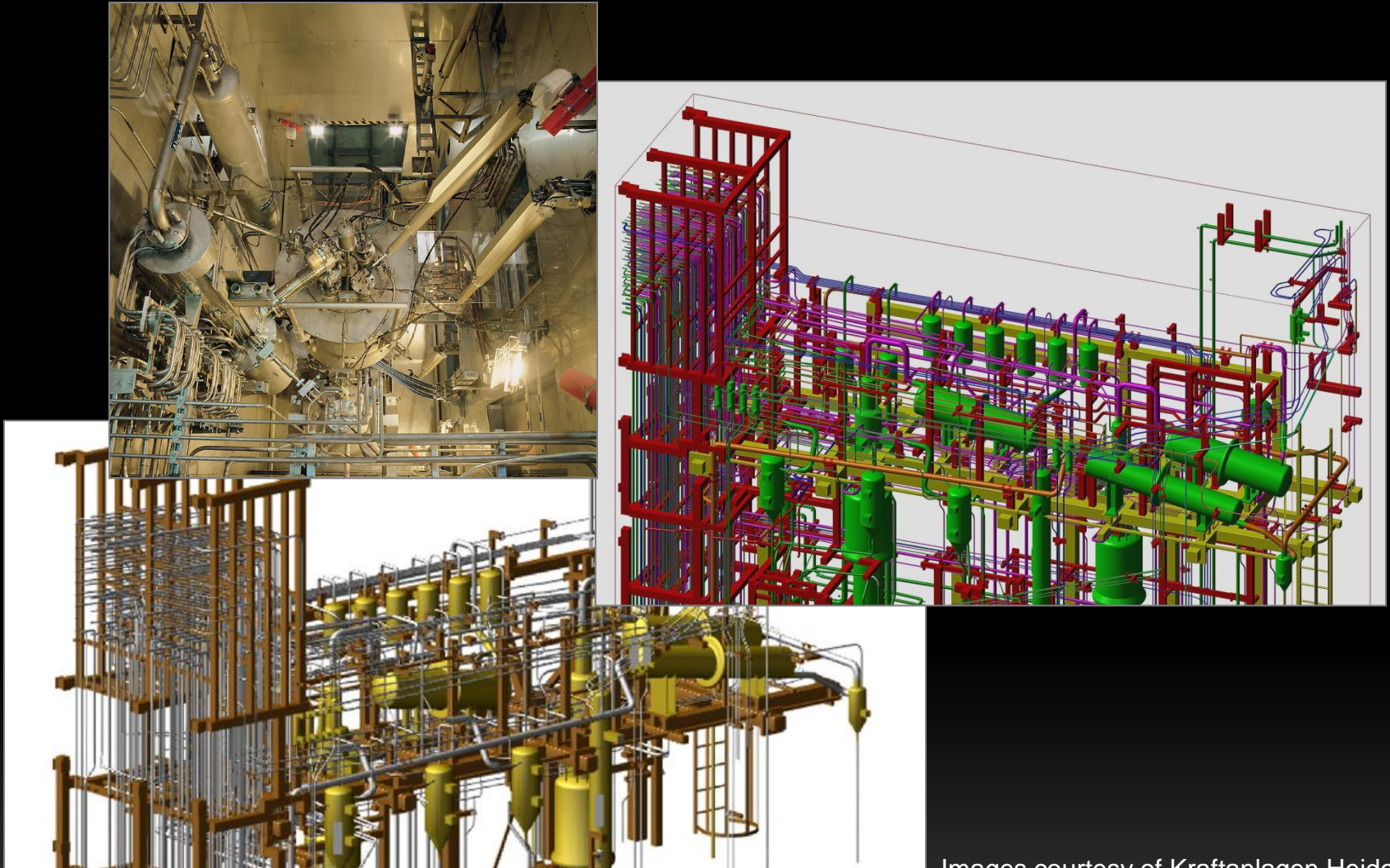

Images courtesy of Kraftanlagen Heidelberg

# AEC Suites





# BIM in the Future



Autodesk BIM 360

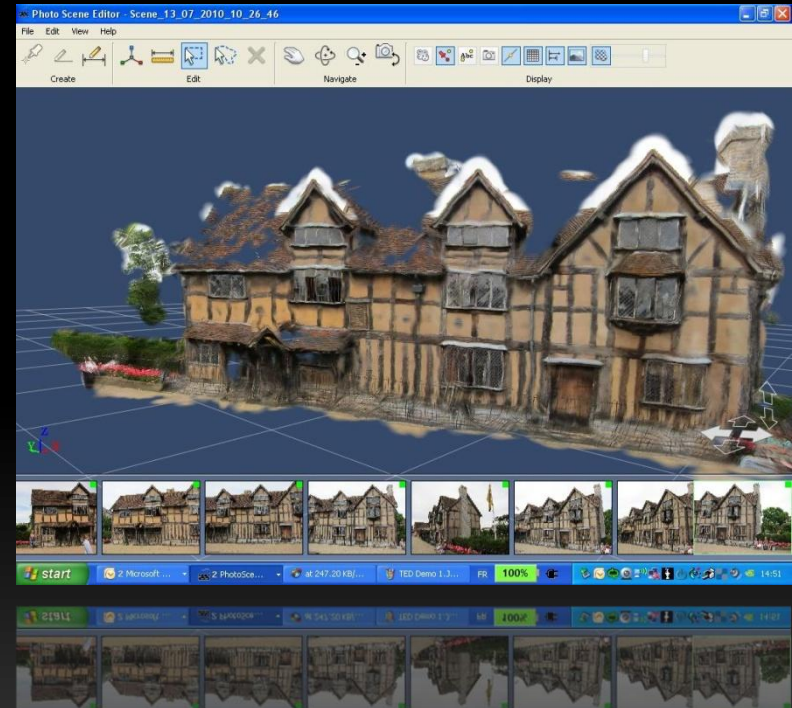
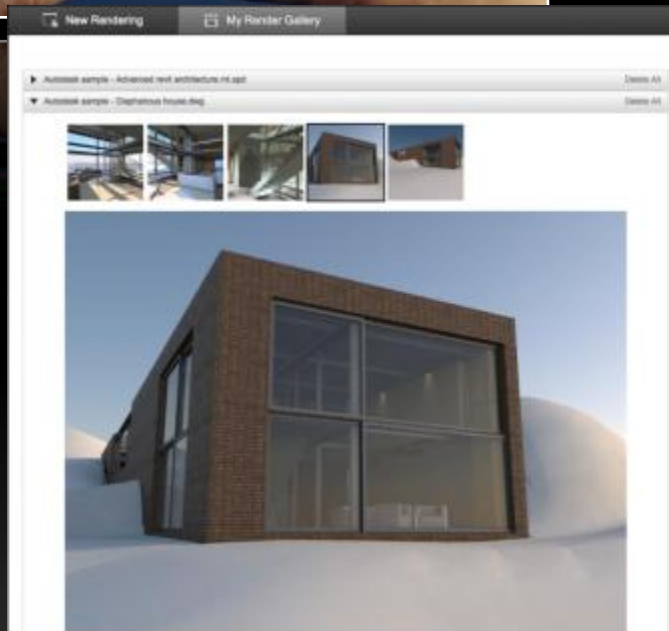

# Driving Growth in AEC

- Industry challenges represent opportunity
  - Building Information Modeling
  - Influence the Value Chain
  - Expanding Share of Wallet
  - New Segments
  - Suites



# Autodesk®